

NO.	DESCRIPTION	QTY	UNIT	REMARKS
1	Concrete (Grade 30)	1200	m ³	For foundation & walls
2	Concrete (Grade 20)	800	m ³	For slabs & beams
3	Reinforcement (Fe 55)	150	metric tons	For all concrete work
4	Bricks (Red)	200000	nos	For masonry work
5	Cement (OPC 42.5)	500	metric tons	For all concrete & masonry
6	Sand	10000	m ³	For concrete & masonry
7	Aggregate (20mm)	10000	m ³	For concrete & masonry
8	Aggregate (40mm)	10000	m ³	For concrete & masonry
9	Paint (Emulsion)	100	metric tons	For wall & ceiling
10	Paint (Acrylic)	50	metric tons	For wall & ceiling

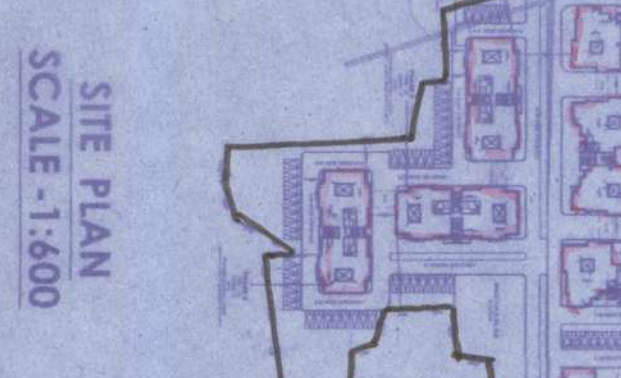
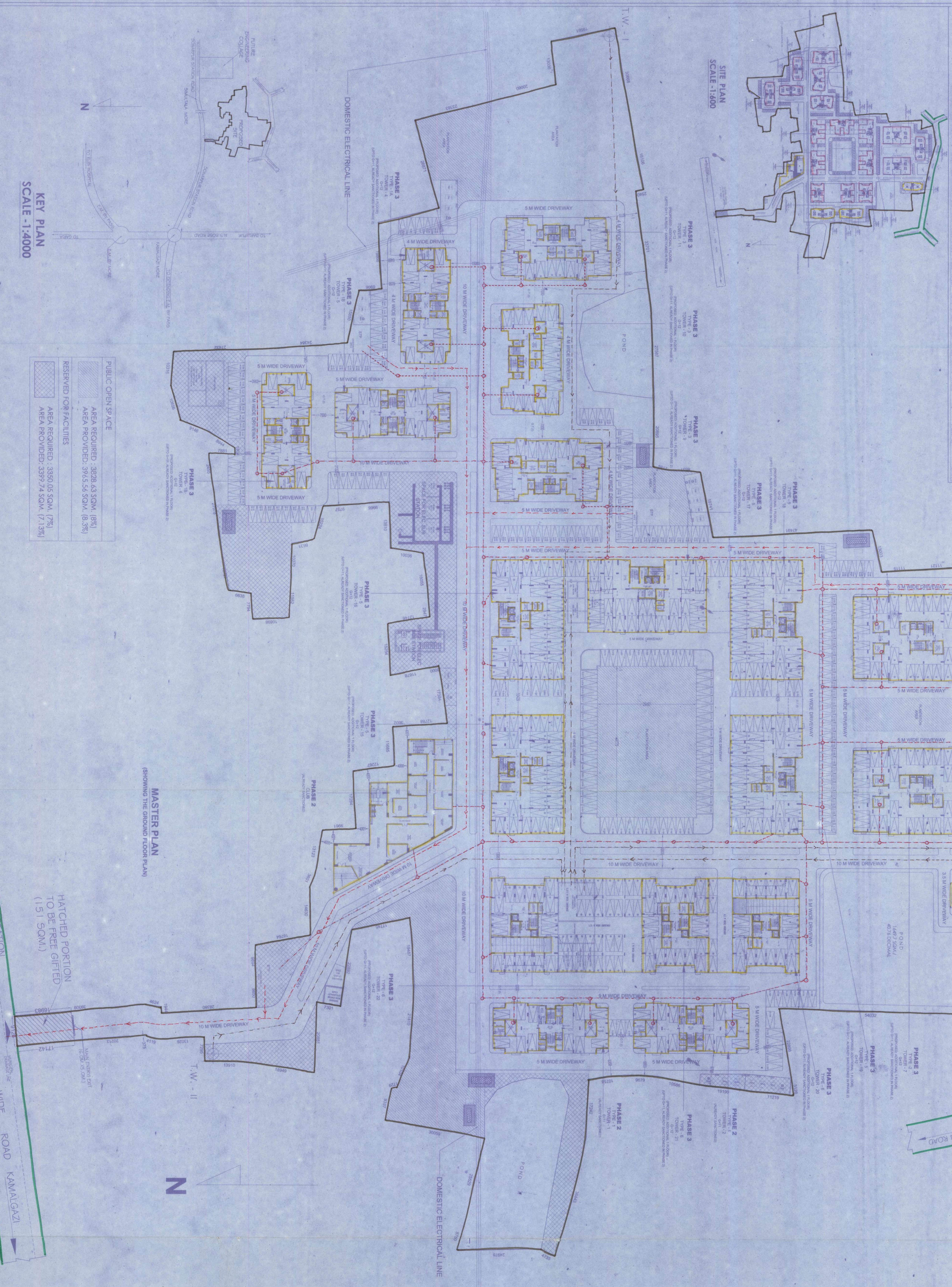
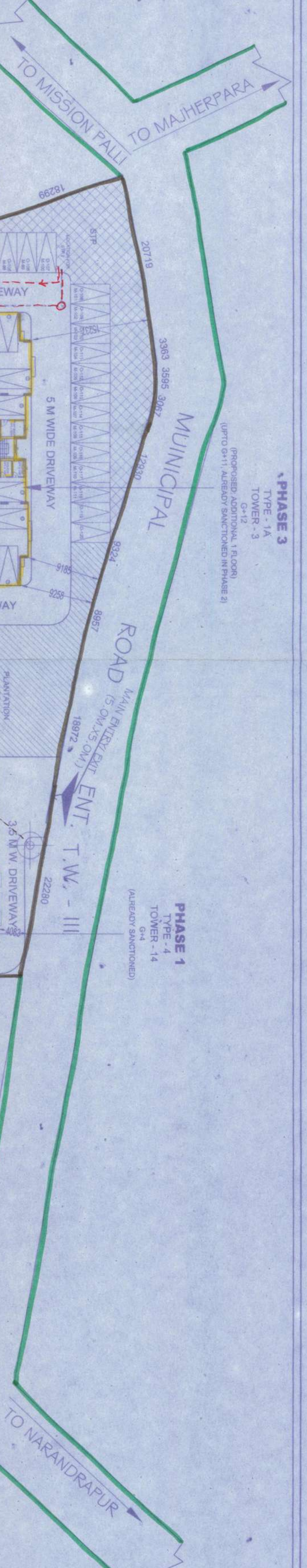

KEY PLAN
SCALE 1:4000

PUBLIC OPEN SPACE

AREA REQUIRED: 3828.43 SQ.M. (85%)
AREA PROVIDED: 3763.55 SQ.M. (85%)
RESERVED FOR FACILITIES:
AREA REQUIRED: 3380.05 SQ.M. (7%)
AREA PROVIDED: 3399.74 SQ.M. (7.13%)

DETAILED AREA CALCULATION OF PHASE 3

NO.	DESCRIPTION	AREA (SQ.M.)	REMARKS
TOWER 1	Sanctioned floor area	1200	Proposed floor area
TOWER 2	Sanctioned floor area	1200	Proposed floor area
TOWER 3	Sanctioned floor area	1200	Proposed floor area
TOWER 4	Sanctioned floor area	1200	Proposed floor area
TOWER 5	Sanctioned floor area	1200	Proposed floor area
TOWER 6	Sanctioned floor area	1200	Proposed floor area
TOWER 7	Sanctioned floor area	1200	Proposed floor area
TOWER 8	Sanctioned floor area	1200	Proposed floor area
TOWER 9	Sanctioned floor area	1200	Proposed floor area
TOWER 10	Sanctioned floor area	1200	Proposed floor area
TOWER 11	Sanctioned floor area	1200	Proposed floor area
TOWER 12	Sanctioned floor area	1200	Proposed floor area
TOWER 13	Sanctioned floor area	1200	Proposed floor area
TOWER 14	Sanctioned floor area	1200	Proposed floor area
TOWER 15	Sanctioned floor area	1200	Proposed floor area
TOWER 16	Sanctioned floor area	1200	Proposed floor area
TOWER 17	Sanctioned floor area	1200	Proposed floor area
TOWER 18	Sanctioned floor area	1200	Proposed floor area
TOWER 19	Sanctioned floor area	1200	Proposed floor area
TOTAL		22500	

APPROVED
Date: 22/11/2023

For Office Use:

PROJECT NAME: PROPOSED ALTERATION & ADDITION OF ONE FLOOR OVER G+41 STORED RESIDENTIAL BUILDING FLOORS (EXCEPT TOWER 1 & 2 AT HOLDING NO. 1177, L.R. DAG NO. 489/489, 491/491, 492/492, 493/493, 494/494, 495/495, 496/496, 497/497, 498/498, 499/499, 500/500, 501/501, 502/502, 503/503, 504/504, 505/505, 506/506, 507/507, 508/508, 509/509, 510/510, 511/511, 512/512, 513/513, 514/514, 515/515, 516/516, 517/517, 518/518, 519/519, 520/520, 521/521, 522/522, 523/523, 524/524, 525/525, 526/526, 527/527, 528/528, 529/529, 530/530, 531/531, 532/532, 533/533, 534/534, 535/535, 536/536, 537/537, 538/538, 539/539, 540/540, 541/541, 542/542, 543/543, 544/544, 545/545, 546/546, 547/547, 548/548, 549/549, 550/550, 551/551, 552/552, 553/553, 554/554, 555/555, 556/556, 557/557, 558/558, 559/559, 560/560, 561/561, 562/562, 563/563, 564/564, 565/565, 566/566, 567/567, 568/568, 569/569, 570/570, 571/571, 572/572, 573/573, 574/574, 575/575, 576/576, 577/577, 578/578, 579/579, 580/580, 581/581, 582/582, 583/583, 584/584, 585/585, 586/586, 587/587, 588/588, 589/589, 590/590, 591/591, 592/592, 593/593, 594/594, 595/595, 596/596, 597/597, 598/598, 599/599, 600/600, 601/601, 602/602, 603/603, 604/604, 605/605, 606/606, 607/607, 608/608, 609/609, 610/610, 611/611, 612/612, 613/613, 614/614, 615/615, 616/616, 617/617, 618/618, 619/619, 620/620, 621/621, 622/622, 623/623, 624/624, 625/625, 626/626, 627/627, 628/628, 629/629, 630/630, 631/631, 632/632, 633/633, 634/634, 635/635, 636/636, 637/637, 638/638, 639/639, 640/640, 641/641, 642/642, 643/643, 644/644, 645/645, 646/646, 647/647, 648/648, 649/649, 650/650, 651/651, 652/652, 653/653, 654/654, 655/655, 656/656, 657/657, 658/658, 659/659, 660/660, 661/661, 662/662, 663/663, 664/664, 665/665, 666/666, 667/667, 668/668, 669/669, 670/670, 671/671, 672/672, 673/673, 674/674, 675/675, 676/676, 677/677, 678/678, 679/679, 680/680, 681/681, 682/682, 683/683, 684/684, 685/685, 686/686, 687/687, 688/688, 689/689, 690/690, 691/691, 692/692, 693/693, 694/694, 695/695, 696/696, 697/697, 698/698, 699/699, 700/700, 701/701, 702/702, 703/703, 704/704, 705/705, 706/706, 707/707, 708/708, 709/709, 710/710, 711/711, 712/712, 713/713, 714/714, 715/715, 716/716, 717/717, 718/718, 719/719, 720/720, 721/721, 722/722, 723/723, 724/724, 725/725, 726/726, 727/727, 728/728, 729/729, 730/730, 731/731, 732/732, 733/733, 734/734, 735/735, 736/736, 737/737, 738/738, 739/739, 740/740, 741/741, 742/742, 743/743, 744/744, 745/745, 746/746, 747/747, 748/748, 749/749, 750/750, 751/751, 752/752, 753/753, 754/754, 755/755, 756/756, 757/757, 758/758, 759/759, 760/760, 761/761, 762/762, 763/763, 764/764, 765/765, 766/766, 767/767, 768/768, 769/769, 770/770, 771/771, 772/772, 773/773, 774/774, 775/775, 776/776, 777/777, 778/778, 779/779, 780/780, 781/781, 782/782, 783/783, 784/784, 785/785, 786/786, 787/787, 788/788, 789/789, 790/790, 791/791, 792/792, 793/793, 794/794, 795/795, 796/796, 797/797, 798/798, 799/799, 800/800, 801/801, 802/802, 803/803, 804/804, 805/805, 806/806, 807/807, 808/808, 809/809, 810/810, 811/811, 812/812, 813/813, 814/814, 815/815, 816/816, 817/817, 818/818, 819/819, 820/820, 821/821, 822/822, 823/823, 824/824, 825/825, 826/826, 827/827, 828/828, 829/829, 830/830, 831/831, 832/832, 833/833, 834/834, 835/835, 836/836, 837/837, 838/838, 839/839, 840/840, 841/841, 842/842, 843/843, 844/844, 845/845, 846/846, 847/847, 848/848, 849/849, 850/850, 851/851, 852/852, 853/853, 854/854, 855/855, 856/856, 857/857, 858/858, 859/859, 860/860, 861/861, 862/862, 863/863, 864/864, 865/865, 866/866, 867/867, 868/868, 869/869, 870/870, 871/871, 872/872, 873/873, 874/874, 875/875, 876/876, 877/877, 878/878, 879/879, 880/880, 881/881, 882/882, 883/883, 884/884, 885/885, 886/886, 887/887, 888/888, 889/889, 890/890, 891/891, 892/892, 893/893, 894/894, 895/895, 896/896, 897/897, 898/898, 899/899, 900/900, 901/901, 902/902, 903/903, 904/904, 905/905, 906/906, 907/907, 908/908, 909/909, 910/910, 911/911, 912/912, 913/913, 914/914, 915/915, 916/916, 917/917, 918/918, 919/919, 920/920, 921/921, 922/922, 923/923, 924/924, 925/925, 926/926, 927/927, 928/928, 929/929, 930/930, 931/931, 932/932, 933/933, 934/934, 935/935, 936/936, 937/937, 938/938, 939/939, 940/940, 941/941, 942/942, 943/943, 944/944, 945/945, 946/946, 947/947, 948/948, 949/949, 950/950, 951/951, 952/952, 953/953, 954/954, 955/955, 956/956, 957/957, 958/958, 959/959, 960/960, 961/961, 962/962, 963/963, 964/964, 965/965, 966/966, 967/967, 968/968, 969/969, 970/970, 971/971, 972/972, 973/973, 974/974, 975/975, 976/976, 977/977, 978/978, 979/979, 980/980, 981/981, 982/982, 983/983, 984/984, 985/985, 986/986, 987/987, 988/988, 989/989, 990/990, 991/991, 992/992, 993/993, 994/994, 995/995, 996/996, 997/997, 998/998, 999/999, 1000/1000

OWNER: DEVALONE DEVELOPERS LTD.
Sole Proprietor: DEVALONE DEVELOPERS LTD.

ARCHITECT: SHRUTI KUMAR DASNI
4, ROAD STREET, KOKKA, RAJASTHAN, INDIA

DATE: 22/11/2023